

# DOOR / WINDOW SENSOR

CONTACT & TEMPERATURE SENSOR



Quick Start Guide



Works with  
**Apple HomeKit**

**FIBARO**  
HOME INTELLIGENCE



Scan the code to  
read the manual

## Support

If you need help configuring the FIBARO Door/Window Sensor, follow our guides and technical manuals available at: [manuals.fibaro.com/en/hk-door-window-sensor](https://manuals.fibaro.com/en/hk-door-window-sensor)

## Package Contents

Every Door/Window Sensor has a unique HomeKit Setup Code. You will find the setup code on back cover of the Quick Start Guide.



Quick Start Guide,  
Quick Manuals,  
Warranty Terms



Magnet

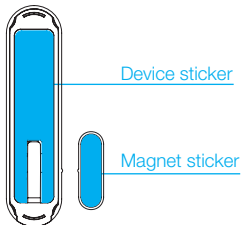

Mounting parts



Device

## FIBARO app

Download the FIBARO for HomeKit application from the App Store.

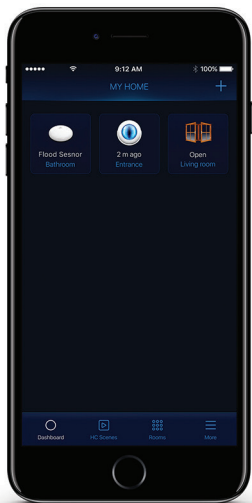

[homekit.fibaro.com/app](https://homekit.fibaro.com/app)



## First launch

### Step 1

Take the cover off

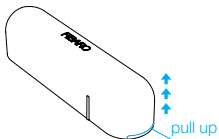

Fig. 1

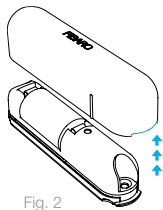

Fig. 2

### Step 2

Remove the battery blocker and check if the battery is placed correctly

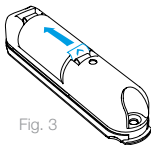

Fig. 3

### Step 3

Close the cover

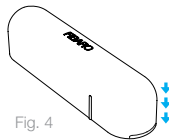

Fig. 4

## First launch

### Step 4

Open the FIBARO app and tap Add accessory icon



### Step 5

Application will guide you through the pairing process

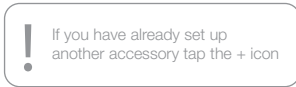
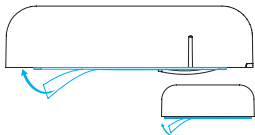

Fig. 5

## First launch

### Step 6

Carefully remove one protective layer from the double-sided stickers included in the package. Apply the stickers to the sensor and magnet.



*\* you can also install device with screws  
(not included)*

Fig. 6

### Step 7

Peel off protective layer from the sensor and magnet

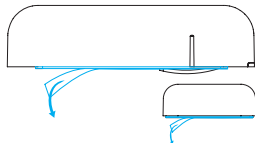

Fig. 7

### Step 8

Stick the sensor onto the frame and magnet onto the moving part of the door/window (no further than 5 mm from the sensor)



Fig.8

## Resetting the Door/Window Sensor to factory defaults:

1. Open the cover
2. Press the button 3 times then press and hold the button

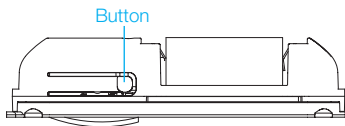

Fig. 9

3. When the LED glows, release the button
4. Click the button again to confirm



┌

└

HomeKit Setup Code is needed to securely add accessory  
to your home. You may need it in case of re-pairing.  
Remember to keep it in safe place. Nobody but you has a copy.  
FIBARO cannot recover the HomeKit setup code for you.

Room: .....

Write down the location of the device.